

safe · timeless · beautiful



markilux Roof Festoon

Give functional airiness and a homely atmosphere to your interior shading



markilux *Roof Festoon*

Give functional airiness and a homely atmosphere to your interior shading

- design features**
- the roof festoon effect creates a cozy atmosphere
- technical highlights**
- large inside areas can also be shaded - easily and simply
 - trevira CS fabric air-permeable and heat-resistant - permanently flame-retardant in compliance with DIN 4102 B1 / M1 Non Feu (B+F) / Classe 1 (I) / BS 5867 (GB)
 - easy operation with hand cord-pull up to a pitch of 20°
 - systems up to 100 cm in width and horizontally installed are also available with hooked staff
 - stainless steel tension wires made of polished steel wire
 - special wire tensioners make the tensioning process easy and safe
 - roof festoon cover with the support rods already inserted
 - when using a hand cord-pull a cord stretcher guides the pull-cord at the operating point
 - awning made individually to your specific order so that it fits your conservatory, pergola or glass roof perfectly
- optional accessories**
- motor drive with two pull-cords
 - sunis sun sensor in combination with the roof festoon and RTS motor

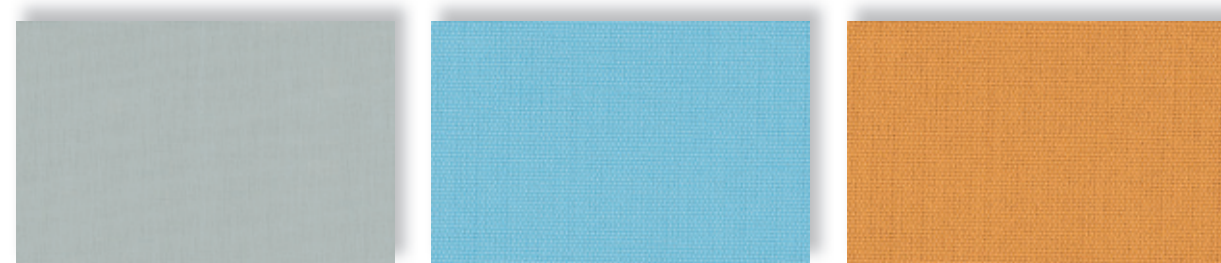

117 08

117 10

117 11

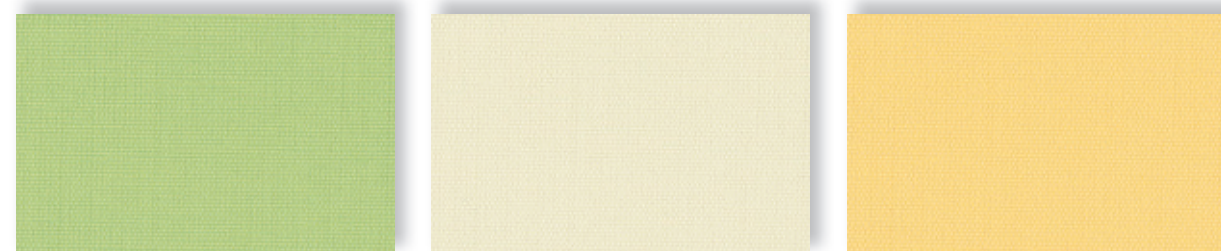

117 16

117 32

117 41

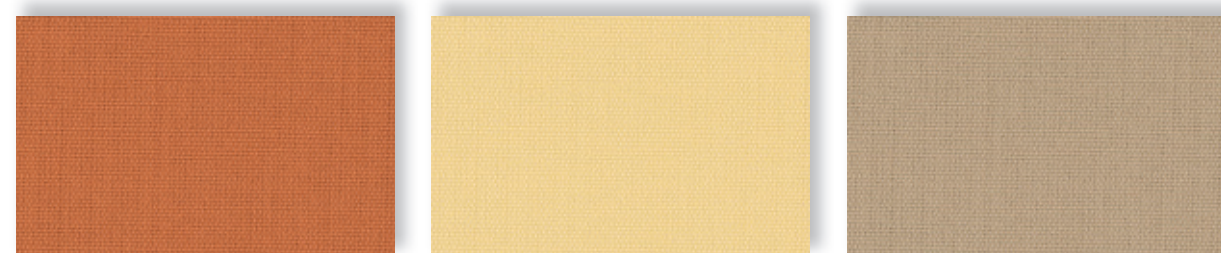

117 82

117 71

117 97

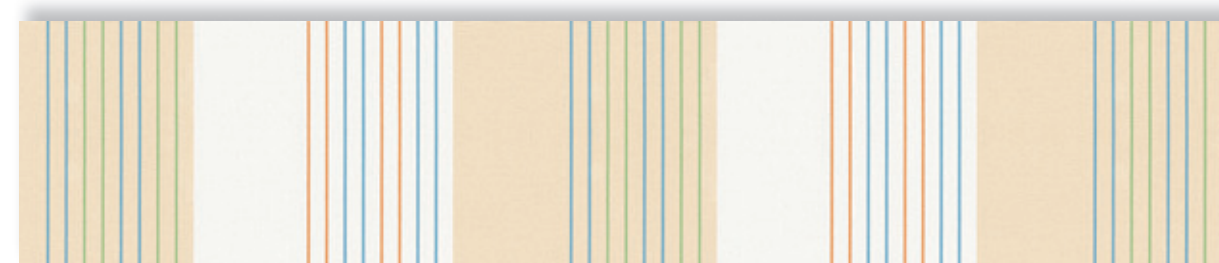

207 87

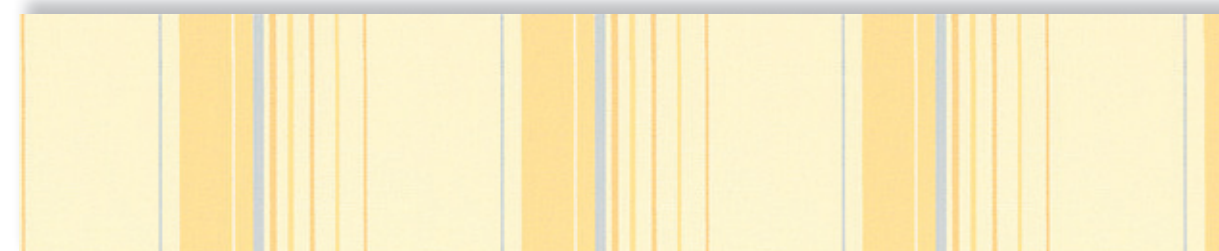





208 01

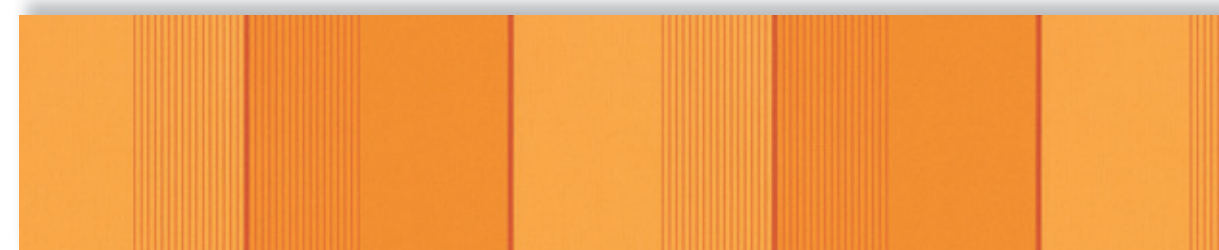

161 81



161 82

Fabric Ref.				Material	 permanently flame retardant
161 81 161 82	0,35 mm	185 g/m ²	6	100% Polyester (Trevira CS)	DIN 4102-B1 M1 Non Feu (B+F) Classe 1 (I) BS 5867 (GB) EN 13772
208 01 207 87	0,45 mm	260 g/m ²	6	100% Polyester (Trevira CS)	DIN 4102-B1 M1 Non Feu (B+F) Classe 1 (I) BS 5867 (GB) EN 13772
117 08 117 10 117 11 117 16 117 32 117 41 117 62 117 71 117 97	0,35 mm	185 g/m ²	6	100% Polyester (Trevira CS)	DIN 4102-B1 M1 Non Feu (B+F) Classe 1 (I) BS 5867 (GB) EN 13772

RAL colours:

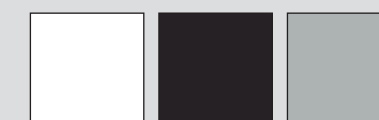

How to measure up for your markilux roof festoon

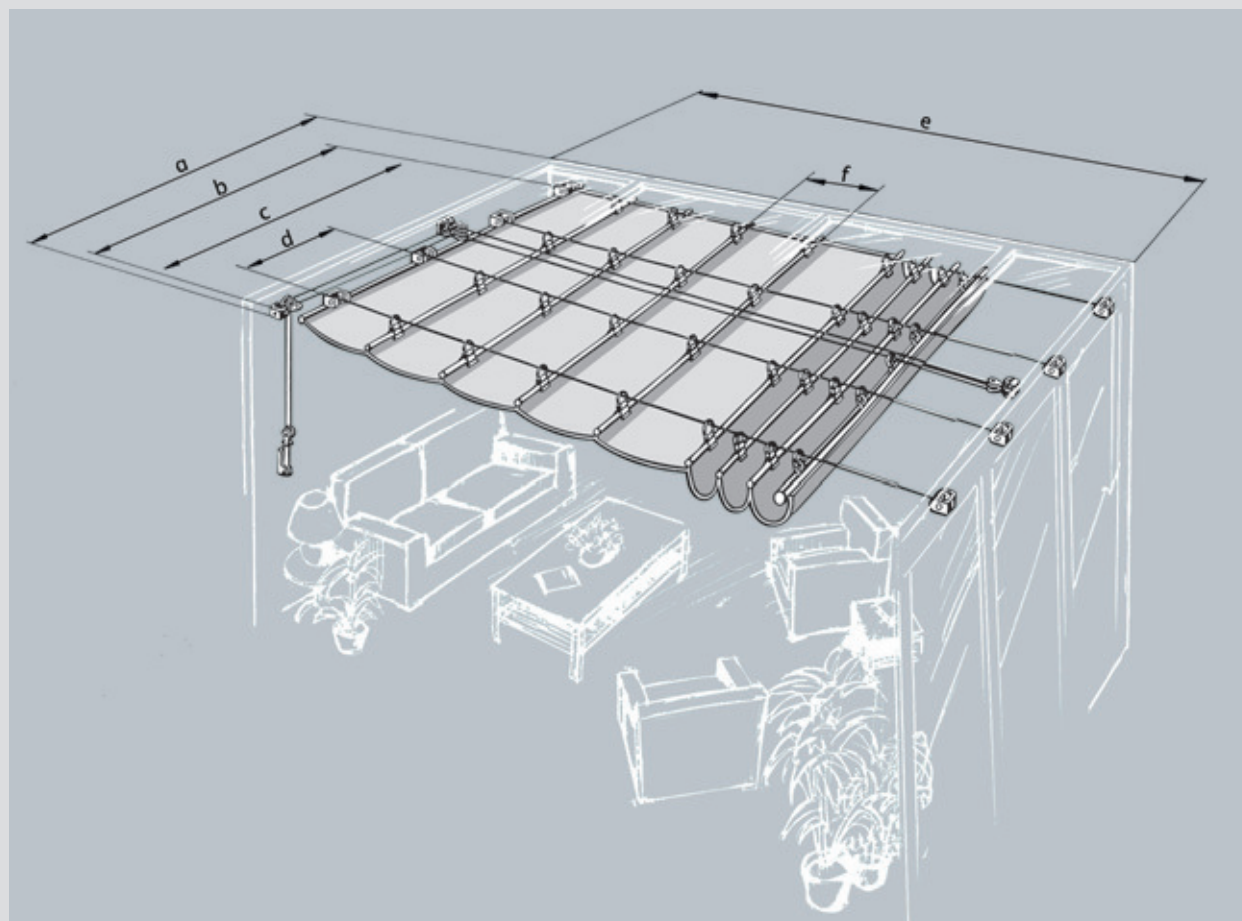

a = room width
b = Roof Festoon width
c = fabric width
d = wire separation
e = room length
f = approx. 25 cm

Start by determining the length and breadth of the room. Obstacles such as light fittings, beams, protruding pieces of wall, air ducts etc. should be taken into account. markilux roof festoons can only be rectangular in shape. To arrive at the required fabric width you should deduct 3 cm from each side i.e. room width less 6 cm at the narrowest point. The outermost wire on each side is positioned approximately 3 cm from the edge of the material.

As long as you do not exceed the maximum of 100 cm you yourself can decide what gap to leave between each pair of wires. The wires must run parallel to one another and with the edge of the roof festoon. We recommend you fix the roof festoon below beams, framework etc. The number of wires required for each particular width is laid down in the price list. Additional wires can be supplied on request (surcharge).

The cover is stitched together from panels of material which run contrary to the extension of the festoon.

A seam separation of approximately 25 cm results in a collapsed fabric height of approximately 16 cm when the roof festoon is retracted.

Please be sure to notify us if a number of roof festoons are to be hung next to one another.

Sun shading products made of material can stretch. When roof festoons are hung next to one another we cannot guarantee that the seams will always match up perfectly. It is not possible to get the patterns of striped materials to match up. Please use plain fabrics.

Tolerances of around 1% must be expected where textiles are concerned.



When ordering the following measurements and information will be required:

- roof festoon width (room width less 6 cm)
- extension (room length)
- fabric no.
- whether fixing brackets and front profile should be in the standard colours white, brown or silver metallic
- fixing brackets and front profile
- as above but including the motor casing and its brackets
- any additional wires if required
- face or soffit fixture

extension	No. of wires	width								
		100 ²⁶⁾	150	200	250	300	350	400	450	500
		100	101-150	151-200	201-250	251-300	301-350	351-400	401-450	451-500
		2	3	3	4	4	5	5	6	6
94										
140										
188										
234										
282										
328										
376										
422										
470										
516										
564										
610										

dimensions in cm





The cord pulley system has one drive cord, the motorised version two. Additional support wires can be supplied if required (surcharge).
 Depth of the material when retracted:
 · up to an extension of 234 cm = approximately 18 cm
 · up to an extension of 422 cm = approximately 26 cm
 · up to an extension of 610 cm = approximately 36 cm
 The roof festoon will work perfectly well up to an angle of 20°. It is not possible to use a sun sensor with a roof festoon. Intermediate widths and extensions can be supplied.
 In the case of a row of electrically driven roof festoons operating simultaneously the same speed of rotation of the motors cannot be guaranteed.

 = cord pulley system as standard
 = motor as standard (incurs a surcharge) (minimum width for motor operation 151 cm)

26) Instead of a cord pulley system also available with hooked rod (operation by hooked rod only possible when fitted horizontally).

configuration options	operation type	
	radio-controlled motor	○
	motor	○
	stainless steel winding handle with bayonet fitting	-
	cord pulley system	●
	operating rod	○
	covers	
	acrylic 34 (fabric series 341xx-347xx)	○
	sunsilk SNC (fabric series 324xx/329xx)	○
	transolair (fabric series 339xx)	○
	oversized acrylic (fabric series 349xx)	○
	signature (fabric series 369xx)	○
Soltis 92	-	
PVC fabric	-	
perfortex (fabric series 333xx)	○	
transilk FR (fabric series 319xx)	○	
perla FR (fabric series 374xx/379xx)	○	
Trevira CS	●	
miscellaneous		
Sunis sun sensor	○	

● = fitted as standard
 ○ = optional accessory
 - = not available

frame colours		
	RAL 9016 traffic white	●
	RAL 8019 grey brown	●
	RAL 9006 metallic aluminium	●
	non-standard RAL colour	-

markilux Roof Festoon

Top fixture

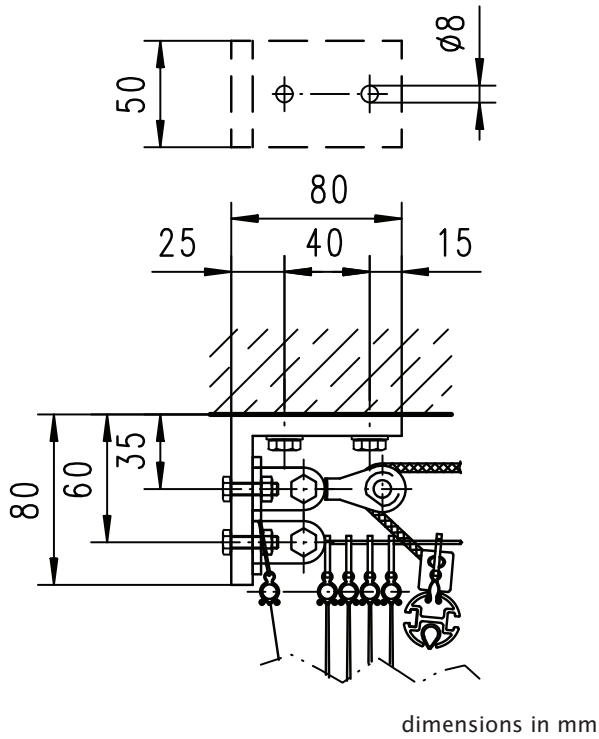

Cord pulley system

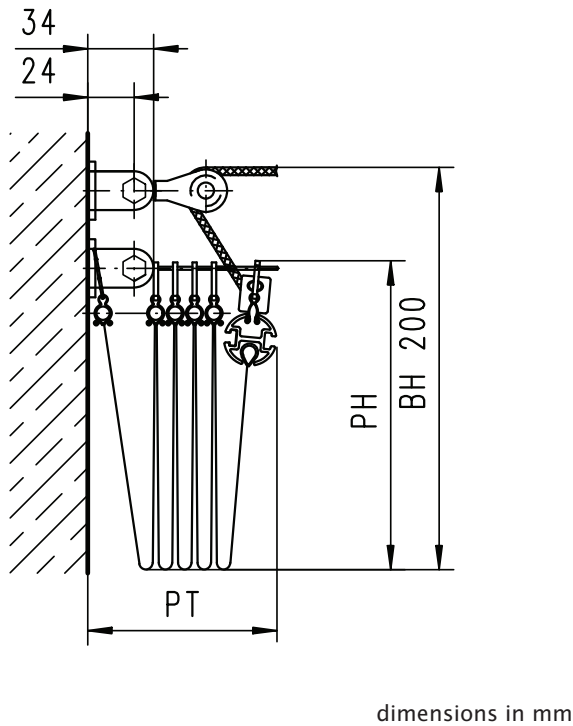

Motorised version

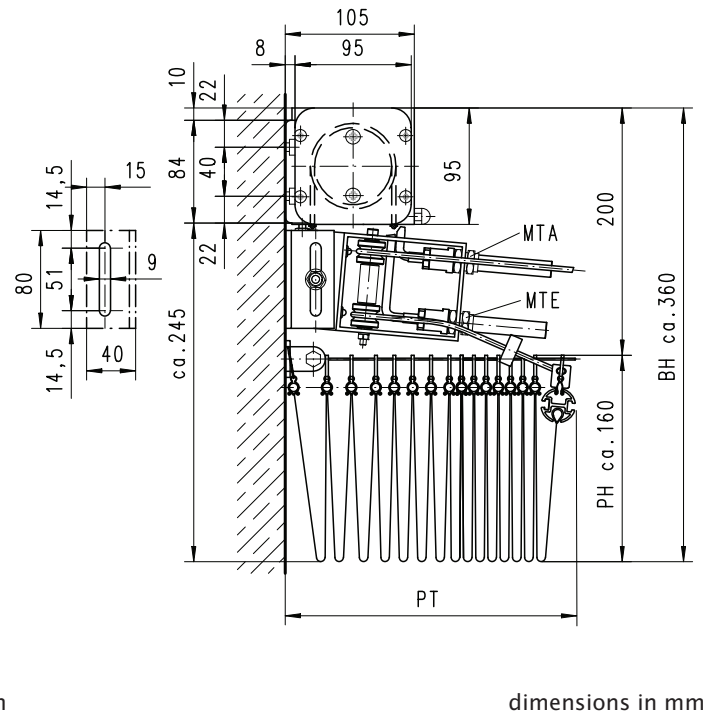

PH = collapsed fabric height
 BH = overall fixture height
 PT = depth of the material when retracted
 MTE = magnetic switch during retraction
 MTA = magnetic switch during extension